



PR SERİSİ HİDROLİK DİREKT EMNİYET VALFLERİ

PR Serisi Hidrolik Direkt Emniyet Valfleri, hidrolik sistemlerde kontrol sisteminin bir parçası olarak rol oynarlar.

Sistem aşırı yüklendiğinde Direkt Emniyet Valfi açılarak pompadan gelen akımın doğrudan yağ deposuna yönlendirilmesini sağlar. Sistemdeki basınç, Direkt Emniyet Valfindeki yay vasıtasıyla belirlenen seviyede kalır. PR Serisi Hidrolik Direkt Emniyet Valfleri, hidrolik devrelerdeki basıncı sınırlamak amacıyla kullanılırlar. Kelebek Vida Ayarlı ve Alyan Anahtar Ayarlı olarak 2 seçeneği bulunmaktadır.

Malzeme	Alüminyum
Vida Ölçüsü	BSP (İsteğe Bağlı: NPT, Metrik)
Sızdırmazlık	Nitril O-ring (NBR)
Çalışma Sıcaklığı	-30 °C ile +110 °C
Isıl İşlem	İç parçalarda
Kullanım Alanı	Genel hidrolik uygulamaları

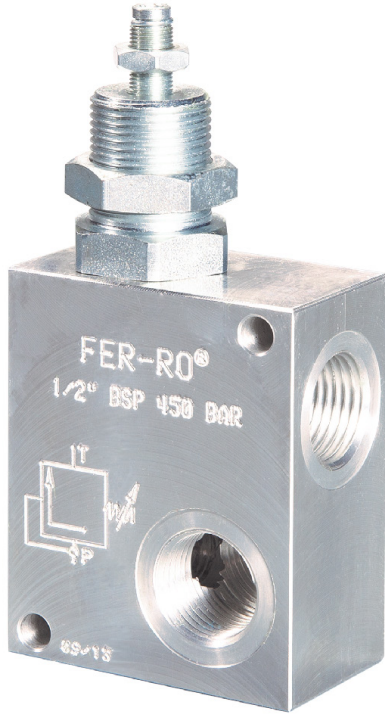

PR SERIES HYDRAULIC PRESSURE RELIEF VALVES

PR Series Hydraulic Pressure Relief Valves act as a part of the control systems in hydraulic systems. When the system gets over loaded, the Pressure Relief Valve opens and flow from the pump is led directly into the hydraulic reservoir. The pressure in the hydraulic system remains on the value determined by the spring on the Pressure Relief Valve.

PR Series Hydraulic Pressure Relief Valves are used to limit the pressure inside of the hydraulic circuits. There are 2 options with Knob Head and Socket Head Screw.

Material	Aluminium
Thread Size	BSP (Upon Request: NPT, Metric)
Sealing	Nitrile O-ring (NBR)
Working Temperature	-30 °C and +110 °C
Heat Treatment	Internal parts
Applications	General Hydraulic Applications

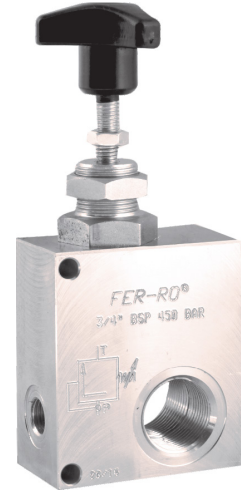
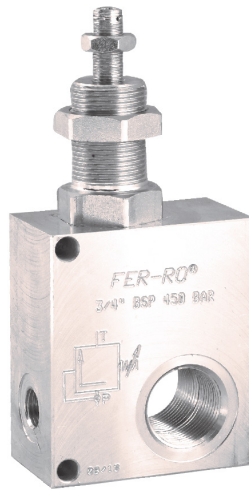

150



FER-RO / PR SERİSİ HİDROLİK DİREKT EMNİYET VALFLERİ

FER-RO / PR SERIES HYDRAULIC PRESSURE RELIEF VALVES

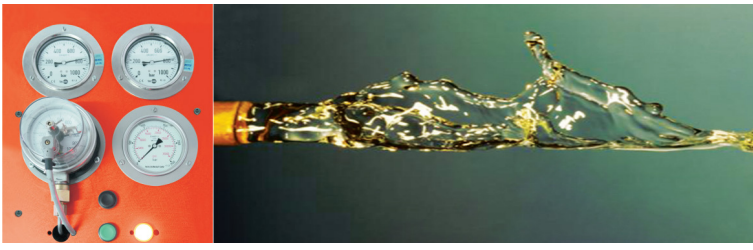

PRSH SERİSİ - ALYAN ANAHTAR AYARLI PRSH SERIES - SOCKET HEAD SCREW

PRKN SERİSİ - KELEBEK VİDA AYARLI PRKN SERIES - KNOB HEAD

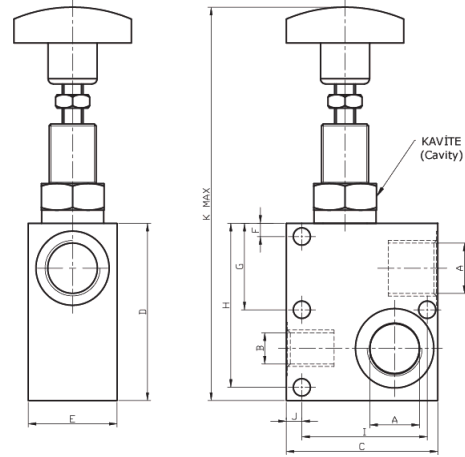
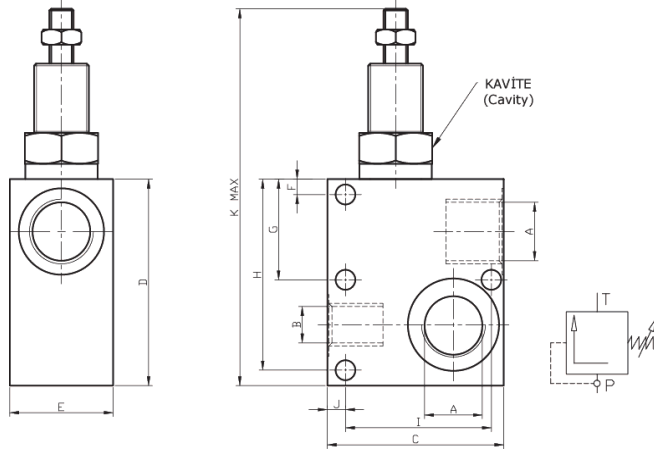

Teknik Özellikler Technical Specifications

Kod (Code)	Vida Ölçüsü (Thread Type) A	Çalışma Basıncı (Working Pressure) Bar	Max. Yağ Akışı (Max. Flow) L/Min	Kavite (Cavity)	Ölçüler - mm (Dimensions - mm)									
					B	C	D	E	F	G	H	I	J	K Max
PRSHG14N	1/4" BSP	50-380	40	8:2	1/4" BSP	48	56	28	-	28	-	37.50	5.25	112
PRSHG38N	3/8" BSP	50-380	40	8:2	1/4" BSP	48	60	28	-	29	-	37.50	5.25	112
PRSHG12N	1/2" BSP	50-380	40	8:2	1/4" BSP	58	67	34	5	-	62	-	1/4" BSP	123
PRSHG34N	3/4" BSP	50-380	80	10:2	1/4" BSP	63	78	38	5.25	-	72.75	-	1/4" BSP	138
PRSHG1N	1" BSP	50-380	100	12:2	1/4" BSP	79	89	49	8	-	81	-	1/4" BSP	168
PRKNG14N	1/4" BSP	50-380	40	8:2	1/4" BSP	48	56	28	-	28	-	37.50	5.25	142
PRKNG38N	3/8" BSP	50-380	40	8:2	1/4" BSP	48	60	28	-	29	-	37.50	5.25	142
PRKNG12N	1/2" BSP	50-380	40	8:2	1/4" BSP	58	67	34	5	-	62	-	1/4" BSP	153
PRKNG34N	3/4" BSP	50-380	80	10:2	1/4" BSP	63	78	38	5.25	-	72.75	-	1/4" BSP	160
PRKNG1N	1" BSP	50-380	100	12:2	1/4" BSP	78	89	49	8	-	81	-	1/4" BSP	190
PRSHLPG14N	1/4" BSP	0-150	40	8:2	1/4" BSP	48	56	28	-	28	-	37.50	5.25	112
PRSHLPG38N	3/8" BSP	0-150	40	8:2	1/4" BSP	48	60	28	-	29	-	37.50	5.25	112
PRSHLPG12N	1/2" BSP	0-150	40	8:2	1/4" BSP	58	67	34	5	-	62	-	1/4" BSP	123
PRSHLPG34N	3/4" BSP	0-150	80	10:2	1/4" BSP	63	78	38	5.25	-	72.75	-	1/4" BSP	138
PRSHLPG1N	1" BSP	0-150	100	12:2	1/4" BSP	79	89	49	8	-	81	-	1/4" BSP	168
PRKNLPG14N	1/4" BSP	0-150	40	8:2	1/4" BSP	48	56	28	-	28	-	37.50	5.25	142
PRKNLPG38N	3/8" BSP	0-150	40	8:2	1/4" BSP	48	60	28	-	29	-	37.50	5.25	142
PRKNLPG12N	1/2" BSP	0-150	40	8:2	1/4" BSP	58	67	34	5	-	62	-	1/4" BSP	153
PRKNLPG34N	3/4" BSP	0-150	80	10:2	1/4" BSP	63	78	38	5.25	-	72.75	-	1/4" BSP	160
PRKNLPG1N	1" BSP	0-150	100	12:2	1/4" BSP	78	89	49	8	-	81	-	1/4" BSP	190

